

## International Commerce Center (ICC)

**Official Name:** International Commerce Center  
**Other Name:** ICC  
**Country:** China  
**City:** Hong Kong  
**Owner/ Developer:** Sun Hung Kai Properties  
**Architect:** Kohn Pederson Fox  
**Structural Engineer:** Arup  
**Building Function:** Office & Hotel  
**Structure Material:** Composite  
**Construction:** 2002 - 2010  
**Height:** Architectural: 484m / Occupied: 468.8m  
**Floors Above Ground:** 108  
**Number of Elevators / Speed:** 83 / 9 m/s (32.4km/h)  
**Tower Gross Floor Area:** 274,000

(CTBUH)



The International Commerce Center works as a gateway into Hong Kong, along with the complementary International Finance Centre across the Victoria harbor. (Building Journal)

## ROOF PLAN

(archrecord.construction.com)

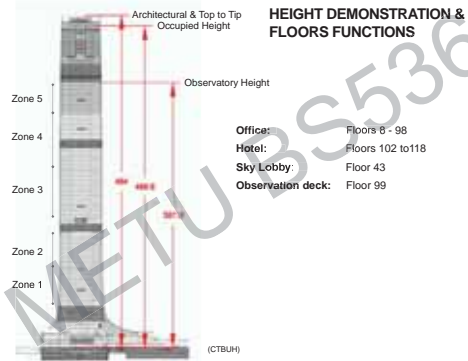
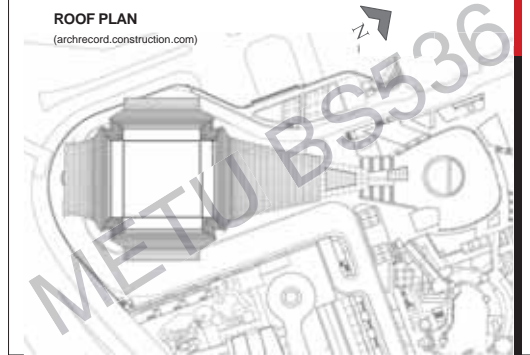

## FLOOR PLANS

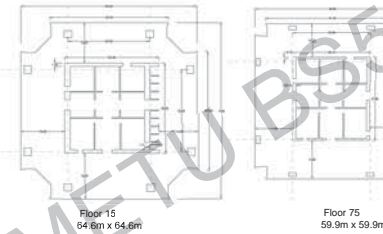

## PARTIAL FLOOR PLANS

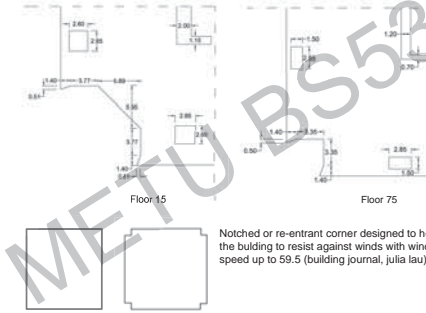

## Curtain wall & Shingled Effect

The Shingle effect accommodates the architectural concept as a reminiscent of the scales of a dragon



(Building Journal)

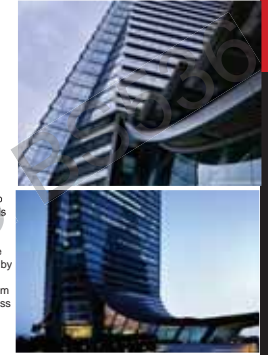

The contoured tail also known as dragon tail, is functional as well as aesthetically please, designed to deflect the downdrafts generated by the tall tower and to shelter pedestrians from tropical rains which pass through Hong Kong regularly. (Building Journal).



The contoured tail also known as dragon tail, is functional as well as aesthetically please, designed to deflect the downdrafts generated by the tall tower and to shelter pedestrians from tropical rains which pass through Hong Kong regularly. (Building Journal).

## STRUCTURE SYSTEM: CORE & OUTRIGGER

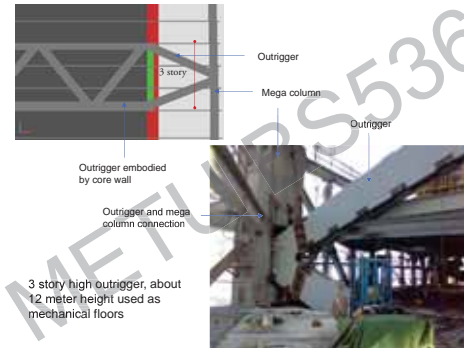
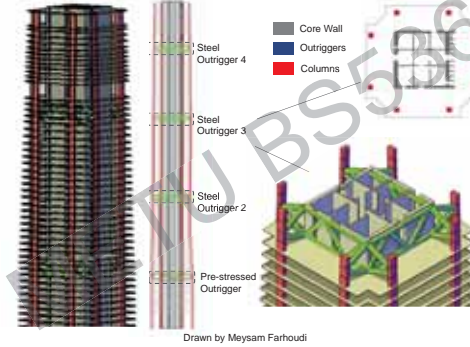

## Column and Façade Inclinations

(Building Journal)

### Two inclination:

- One Degree inclination on upper third of façade
- Three Degree inclination on lower portion of columns

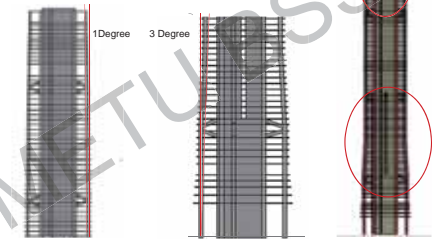

## CONSTRUCTION PROCESS

### Total amount of material used

**Concrete:** 2,400 cubic meter  
**Reinforced bar:** 98,000 ton  
**Structural Steel:** 27,000 ton

(Construction and Contract News)



## USED CONCRETE GRADE

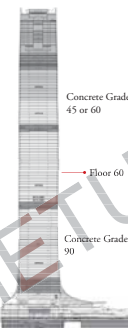

Grade 90 concrete is used up to 60F. The other portion of tower structure uses mainly Grade 45 and Grade 60 concrete (Construction and Contract News).

Connecting joint between the outrigger and mega column is provided with design to cater for the differential deflection similar to the IFC2 project (Construction and Contract News).



The jump form for the construction of the core wall in two operating phases. Note also the set of lift-form (orange in color) on the right side of core wall for the construction of the finger wall (Construction and Contract News).



**References:**

- [1] Building Journal, Redefining Hong Kong Skyline, 2010
- [2] Wong Raymond, A construction Highlight for the International Commerce Center at Kowloon Station West Kowloon, 2008
- [3] Julia Lau, The 3 Tallest Skyscraper in Hong Kong, 2012
- [4] Construction and Contract News, International commerce center, 2008  
<http://archrecord.construction.com/projects/portfolio/2012/05/international-commerce-centre.asp>